



## Important Safeguards

Please read these instructions carefully before using your Drew&Cole Clever Micro Toastie Maker.

- Not suitable for use in conventional ovens, hobs, or grills. Suitable for combination microwave ovens, but only when using the 'microwave' setting.
- Ensure caution is taken when removing cookware from microwave oven as it may be hot.
- Allow metal parts to cool before removing.
- Ensure metal parts are correctly fitted into moulded housing with no exposure, to prevent sparks occurring during cooking in microwave oven.
- Do not use repeatedly more than 4 times before allowing to cool for 30 minutes.
- Not for commercial use. Household use only.
- Do not use for more than 10 minutes continuously.

## Cleaning and Care

Cleaning your Clever Micro Toastie Maker after each use will prolong its life.

- Clean thoroughly before first use.
- Fully disassemble your Clever Micro Toastie Maker to enable thorough cleaning.
- All parts are dishwasher safe.
- If hand washing, do so in warm soapy water with a soft cloth to protect the non-stick coating on metal parts.
- Do not use scouring pads or abrasive chemicals.
- Do not use metal utensils when removing food from your Clever Micro Toastie Maker. Metal utensils may damage the non-stick coating on metal parts.

## Toastie Cooking Times



### Light Browning

2:00 mins + flip + 1:00 min



### Medium Browning

2 mins 30 secs + flip  
+ 1 min 30 secs



### High Browning

3:00 mins + flip + 2:00 min

The product and its packaging have been manufactured from valuable materials that can be recycled. Recycling reduces the amount of refuse and helps to preserve the environment.

Dispose of the packaging at a recycling point that sorts materials by type. Make use of the local facilities provided for collecting paper, cardboard and lightweight packaging.

**drew&cole**

WE MAKE COOKING FUN



**FREE DREW&COLE APP**  
with 100s of recipes,  
inspiration, hints and tips

Register your product at  
[drewandcole.com/support](http://drewandcole.com/support)  
and visit us for...



Join our community...



Catch us all day,  
every day on Sky  
and YouTube too!



Search: 'DrewandColeUK' to  
keep up to date with all the latest  
news, recipes and inspiration.

**drew&cole**  
WE MAKE COOKING FUN



**FREE APP**  
with recipes,  
inspiration,  
hints and tips.

**CLEVER MICRO TOASTIE MAKER**

USER MANUAL

Register your product at  
[drewandcole.com/support](http://drewandcole.com/support)  
and visit us for...



Join our community...



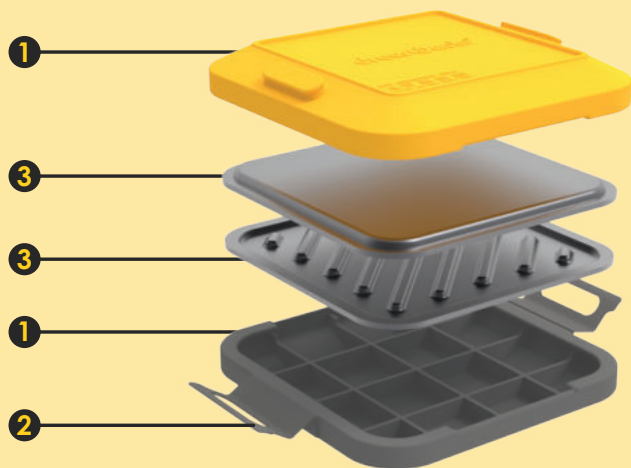

## Product Overview

- 1. Silicone Casing**
- 2. Outercasing clips**  
Designed to securely fasten two outer casings together.
- 3. Grill Plates** Using Advanced Therma-Wave™ Technology, the plates work together to cook toasties similar to a traditional grill.

## ADVANCED THERMAWAVE™ TECHNOLOGY



ThermaWave™ technology harnesses microwave energy to replicate traditional cooking methods delivering crispy and flavourful results.

## Assembly Instructions

1. Make sure the griddle lines on the metal grill plates are aligned in the same direction. Firmly insert the metal grill plates into the silicone casings.
2. Press both assembled sections together.
3. Use the clips on the bottom silicone casing to secure the top section into place.

## Disassembly Instructions

1. Allow the Toaster Maker to cool completely.
2. Release the clips and remove the top section.
3. Flip both sections so the metal grill plates face upward.
4. Carefully lift the metal grill plates out of the silicone casings.

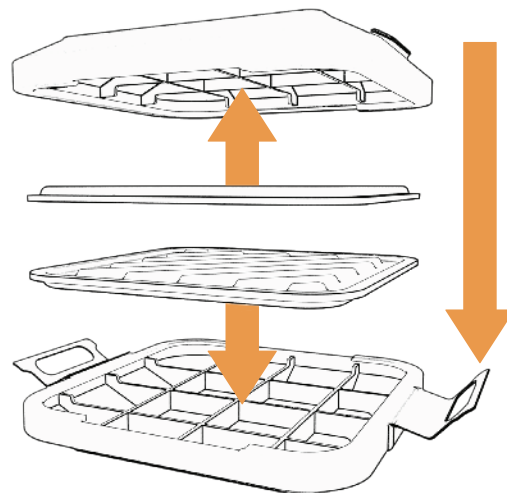

## HOW TO USE

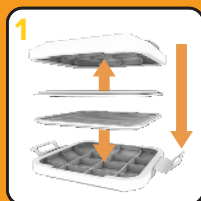

1 Assemble your Drew & Cole Clever Micro Toaster Maker as instructed above.



2 Spread butter on the outer side of the bread and place it on the bottom plate. For optimal results, use bread designed for toasting and ensure all bread is fully enclosed within the silicone casing. Trim to size if needed.



3 Place the ingredients on the bread, keeping them 1cm away from the edges. Place the top slice of bread over it, with the buttered side facing up.

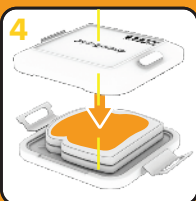

4 Press the top section down and lift the clips upward and over locking tabs to secure both sections together.



5 Place in the microwave on a microwave-safe plate. Set the appropriate cooking time and start.

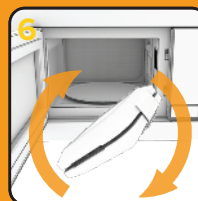

6 Flip your Drew & Cole Clever Micro Toaster Maker midway through cooking.



7 Carefully take it out of the microwave using oven gloves. Release the clips on both sides and serve.



## Microwave Oven times

- Max 1200W microwave oven, timings given are based on a 900W microwave.
- Microwave oven times may vary.
- For repeated use, reduce cooking times by 20 seconds.
- Do not use repeatedly more than 4 times before allowing to cool for 30 minutes.
- Timings may be adjusted to suit your personal tastes.