

# drew & cole<sup>®</sup>

## BARISTA ICE CAFÉ™

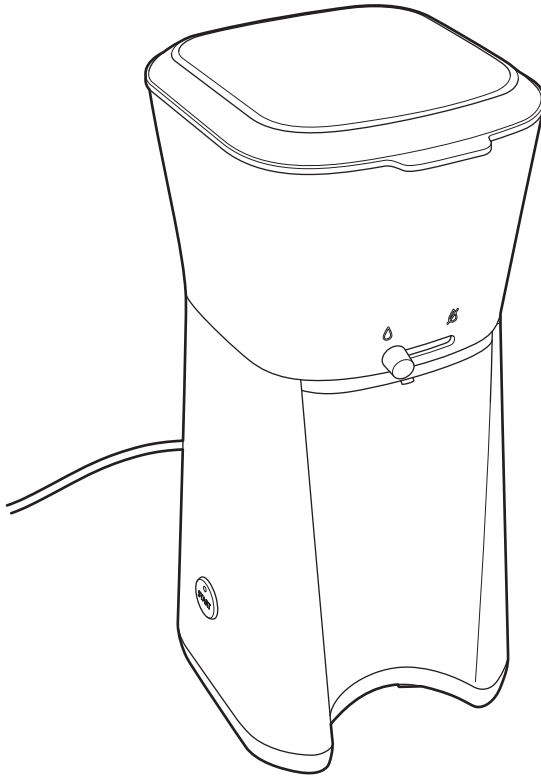

**FREE APP**  
with recipes,  
inspiration,  
hints and tips.

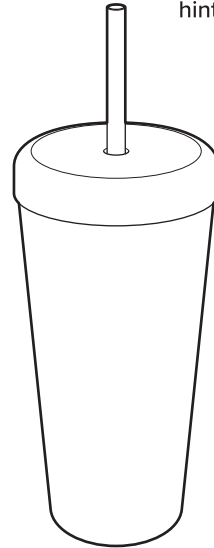

# Iced Coffee Maker

## User Manual

Register your product at  
[drewandcole.com/support](https://drewandcole.com/support)  
and visit us for...

FAQs



Videos



Recipes



Support



Join our community..



# Index

## Topic

---

Important safeguards	03
Box contents	04
Parts of your Iced Coffee Maker	04
Preparing your Iced Coffee Maker	05
Using your Iced Coffee Maker	09
Cleaning your Iced Coffee Maker	11

# Important Safeguards

**When using electrical appliances, basic safety precautions should always be followed including the following:**

- **Read all instructions before using this product.**
- This appliance can be used by children aged from 8 years and above if they have been given supervision or instruction concerning use of the appliance in a safe way and if they understand the hazards involved. Cleaning and user maintenance shall not be made by children unless they are older than 8 and supervised. Keep the appliance and its cord out of the reach of children aged less than 8 years.
- If the supply cord is damaged, it must be replaced by the manufacturer, its service agent or similarly qualified persons in order to avoid a hazard.
- Never use this appliance for anything other than its intended use.
- This appliance is for household use only.
- Do not use this appliance outdoors.
- Never immerse the main body in water or any other liquid.
- Before use, wash the Basket, Filter, To go cup, To go cup lid and straw in warm soapy water then dry thoroughly.
- The lid must be closed before use.
- Do not reuse the Iced Coffee Maker until after the recommended cooling time of 3 minutes.
- This appliance generates heat during use. Adequate precautions must be taken to prevent the risk of burns, scalds, fires or other damage by touching the exterior whilst in use or during cooling.
- Always ensure that your hands are dry before handling the plug or switching the appliance on.
- Ensure all lids are closed during use.
- Always use the appliance on a stable secure and dry level surface.
- This appliance must not be placed on or near any hot surfaces, such as a gas or electric hob.
- Do not use this appliance if it has been dropped. If there any visible signs of damage or if it is leaking.
- Ensure the appliance is switched off and the plug is removed from the mains socket before cleaning or after use.
- Always switch the appliance off and remove the plug from the mains socket and allow to cool before removing or fitting any parts and before cleaning or storing.
- Never let the power cord hang over the edge of the work top, touch hot surfaces or become knotted, trapped or pinched.
- The heating element surface is subject to residual heat after use.
- The appliance must not be placed in a cabinet when in use.
- Cleaning and user maintenance shall not be made by children without supervision.

# Box Contents

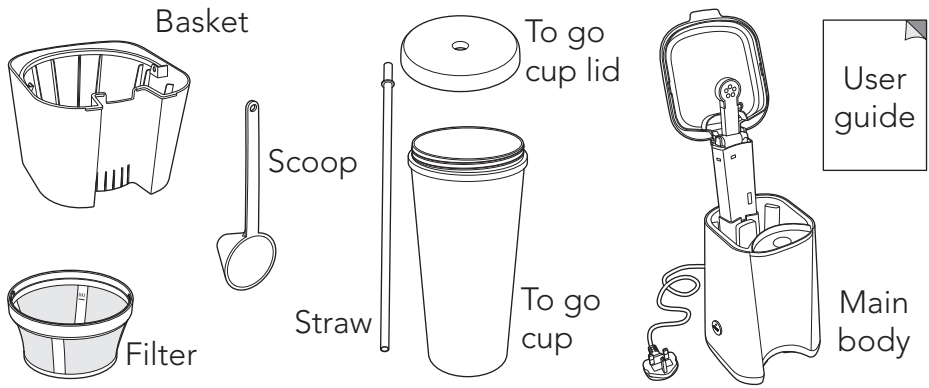

# Parts of Your Iced Coffee Maker

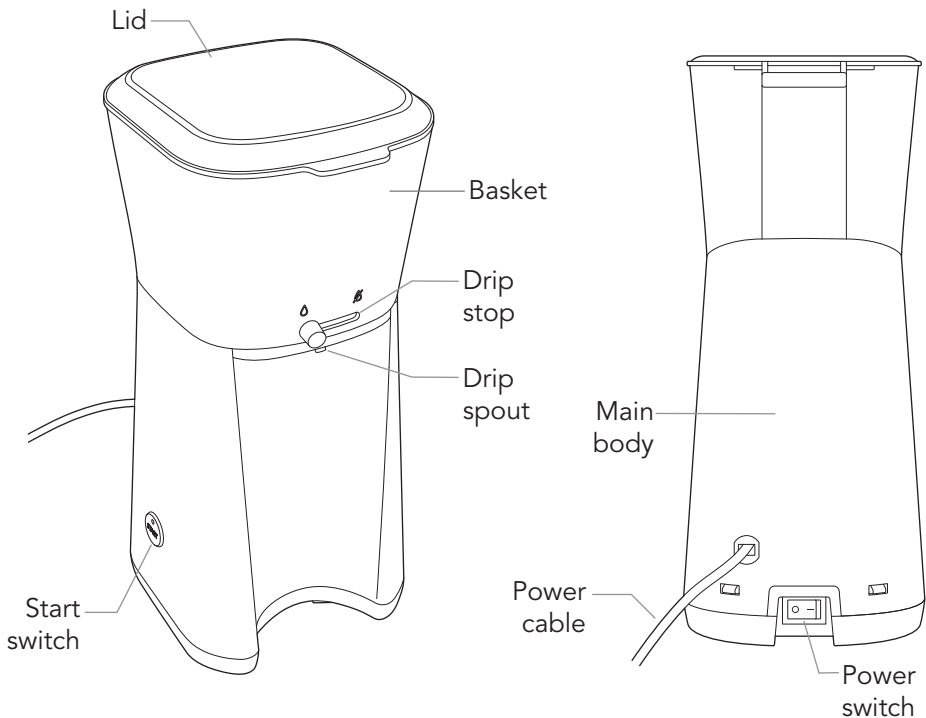

# Preparing Your Iced Coffee Maker

**IMPORTANT:** Before using your Iced Coffee Maker, you must ensure all parts of it have been cleaned.

**CAUTION:** Never immerse the main body in water.

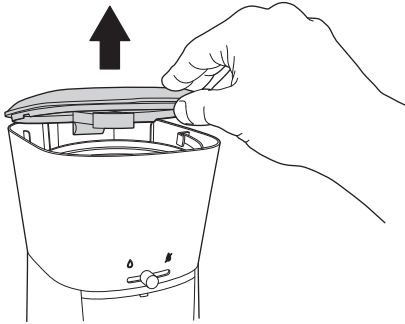

Lift open the lid of your Iced Coffee Maker.

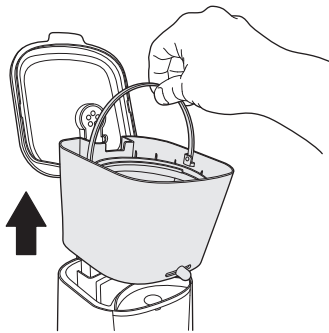

Lift the basket off the top of the main body using the handle stored inside the basket.

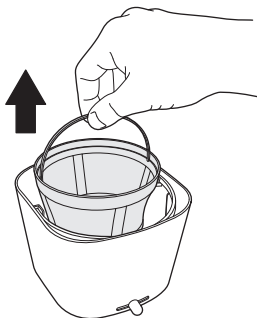

Lift the filter out of the basket using the handle on the top of the filter.

SAVE THESE INSTRUCTIONS- FOR HOUSEHOLD USE ONLY

## Preparing Your Iced Coffee Maker (cont...)

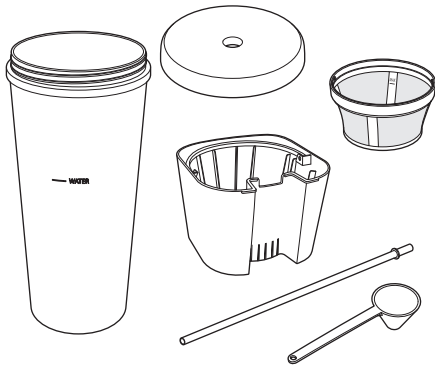

Wash the To go cup, To go cup lid, basket, filter, straw and scoop in warm soapy water then rinse in clean water and then dry thoroughly.

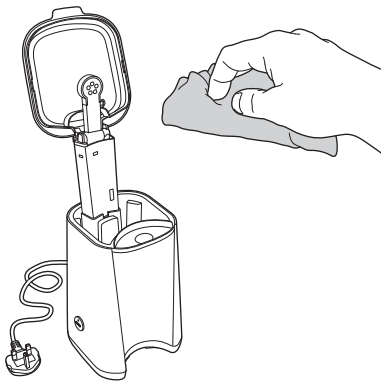

Wipe the outside of the main body with a damp cloth and then dry with a soft cloth.

**IMPORTANT:** Do not clean the main body with abrasive cleaning agents or chemical cleaners.

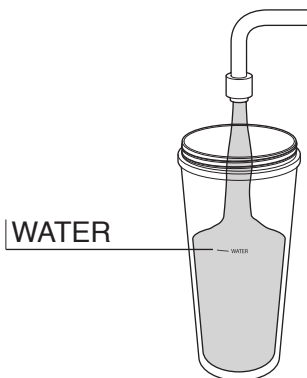

Fill the cup to the WATER mark on the side of the cup.

## Preparing Your Iced Coffee Maker (cont...)

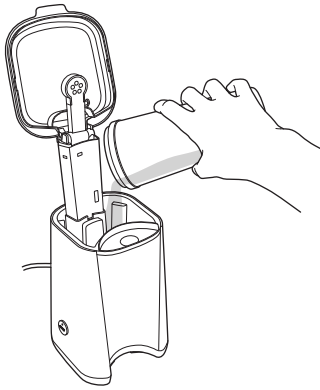

Pour the water into the water tank in the main body of the Iced Coffee Maker as shown in the diagram.

**DO NOT** exceed the water MAX line shown inside the water tank.

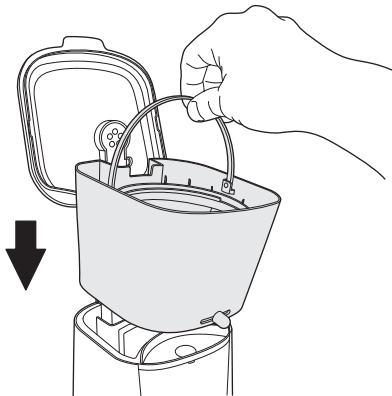

Place the filter back into the basket and place the basket back onto the top of the main body. Lower the lid of the main body back down over the top of the basket.

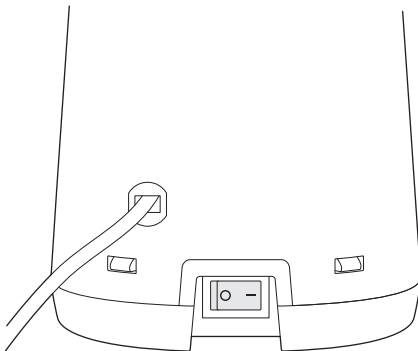

Insert the plug into a mains socket and turn the power on if required.

Press the – end of the power switch (on the back of the appliance) inwards to turn your Iced Coffee Maker on.

## Preparing Your Iced Coffee Maker (cont...)

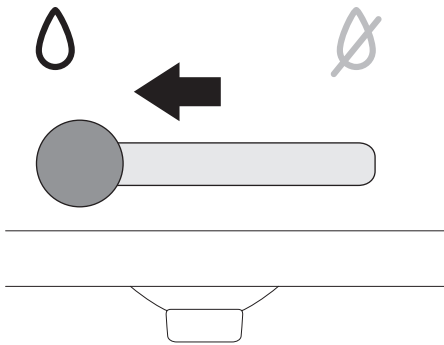

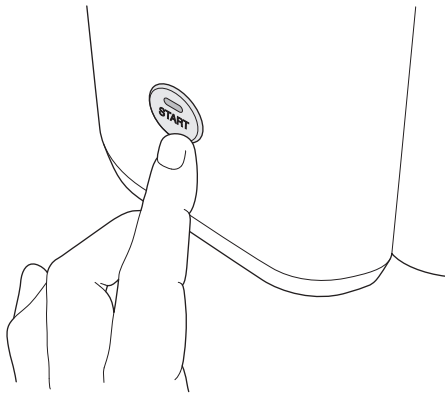

Slide the drip stop to the open position .

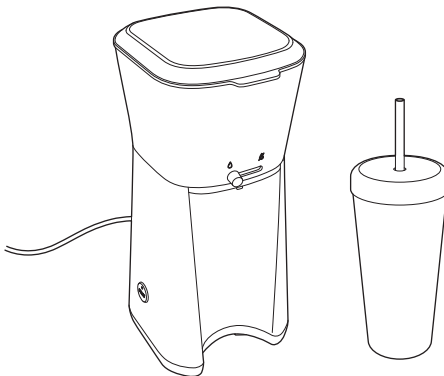

With the lid and straw removed, place the To go cup into the gap in the front of the main body so that it is under the drip spout.

Press the start button on the side of the appliance to start the brewing process. The LED will come on showing the appliance is working.



When the brewing process has completed the LED light goes out (no more water comes out of the drip spout), press the power switch to  position.

Slide the drip stop to the closed position .

Empty and wash the To go cup with clean water.

Your Iced Coffee Maker is now ready for use.



# Using Your Iced Coffee Maker

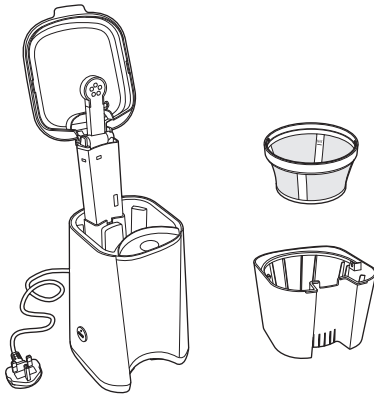

Lift open the lid on the top of your Iced Coffee Maker. Lift the basket off the appliance and remove the filter.

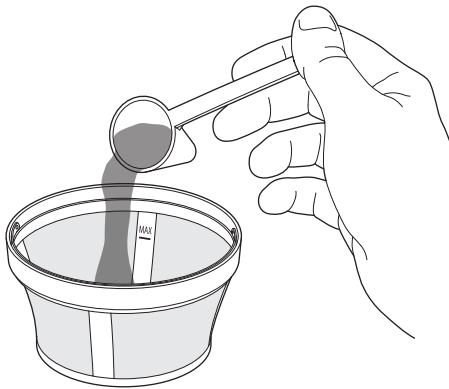

Using the scoop included, add 3 level scoops of ground coffee into the filter.

**IMPORTANT:** Do not add ground coffee above the MAX line as this could cause coffee grounds to be deposited into the To go cup.

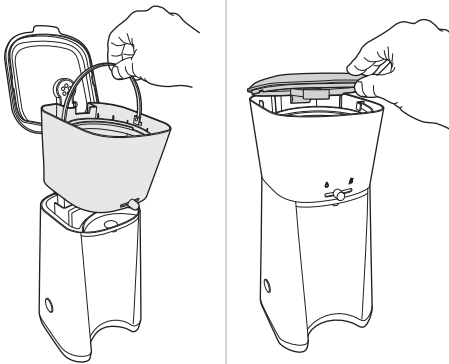

Fill the cup to the water line and pour into the water tank of the main body.

**IMPORTANT:** Do not fill the water tank with ice.

Place the filter back into the basket and place it back on top of the main body and lower the lid.

Fill the To Go Cup with ice up to the ICE mark

## Using Your Iced Coffee Maker (cont...)

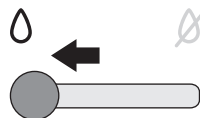
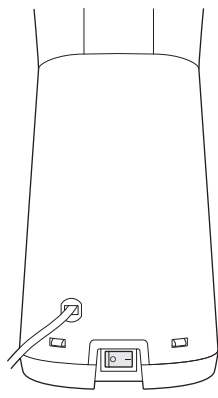

With the lid and straw removed, place the To go cup under the drip spout of the Iced Coffee Maker.

Plug the appliance into the mains and press the power switch on the back of the appliance down to turn it on.

Slide the drip stop to the open  position.

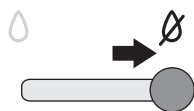
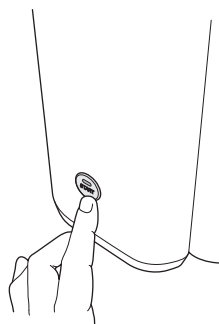

Press the start button on the side of the appliance to start the brewing process. The LED light will come on to show the appliance is working.

Wait 3 to 4 minutes for brewing to complete the LED light will go off, slide the drip stop to the closed position .

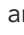
Press the power switch on the back of the appliance to the  position and remove the plug from the wall socket

Add in your favourite coffee flavour and/or milk for coffee just as you like it.

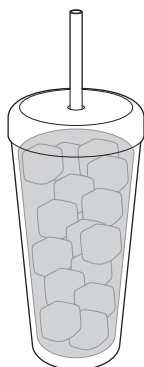
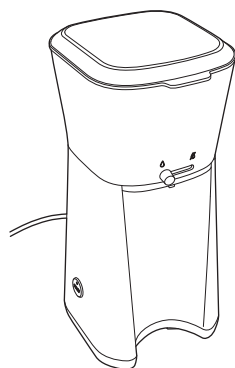

Slot the straw through the hole in the lid and screw it onto the top of the cup.

**IMPORTANT:** Wait 3 minutes before making another cup of coffee or before cleaning your Iced Coffee Maker.

# Cleaning your Iced Coffee Maker

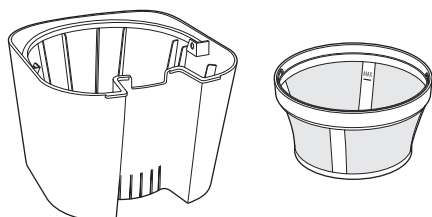

**Hand wash or place in a dishwasher**

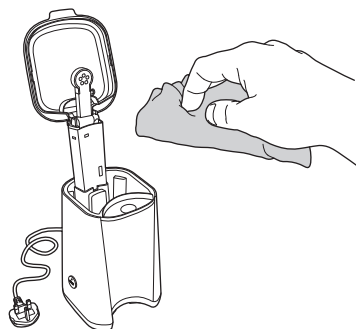

After using your Iced Coffee Maker, allow it to cool then lift the lid and remove the basket and the filter.

Empty the coffee grounds from the filter and rinse under a running tap.

Wash the basket and filter in warm soapy water then place them in the top section of the dishwasher.

**IMPORTANT:** The cup and straw are hand wash ONLY.

Wipe the case of the main unit with a damp cloth then dry with a soft towel.

## Need help? We're here for you.

Please contact our Customer Services Team on:

**Phone:** 0344 800 0631 (UK) / 0412 132 998 (Ireland)

**Email:** [customer care@drewandcole.com](mailto:customer care@drewandcole.com)

**Visit:** [drewandcole.com/support](http://drewandcole.com/support) for FAQ's

The product and its packaging have been manufactured from valuable materials that can be recycled. Recycling reduces the amount of refuse and helps to preserve the environment.

Dispose of the packaging at a recycling point that sorts materials by type. Make use of the local facilities provided for collecting paper, cardboard and light weight packaging.



Appliances marked with this symbol must not be disposed of along with normal household waste!

You are legally obliged to dispose of old appliances separately from household waste.

Information about collection points where old appliances can be disposed of free of charge is available from your local authorities.

# drew & cole<sup>®</sup>

## BARISTA ICE CAFÉ™



### FREE DREW & COLE APP

with 100s of recipes,  
inspiration, hints and tips.



---

Register your product at  
[drewandcole.com/support](https://drewandcole.com/support)  
and visit us for...

FAQs



Videos



Recipes



Support



---

Join our community...



Search: 'Drew&ColeUK' to keep up to date with all  
the latest news, recipes and inspiration.

Distributed by:  
High Street TV, PO Box 7903,  
Corby, NN17 9HY

Model number: CM9433-GS  
V1-04/22

Please recycle our product and  
packaging where facilities exist.  
Check with your Local Authority  
or retailer for recycling in your  
country.

