



## Heater & Humidifier Fan User's Manual

**high**  
street tv  
Need help?  
We're here  
for you

Visit  
**HighStreetTV.com/Support for:**

-  FAQ'S
-  Video Guides
-  Register your product

Join our community  
   

# Quick Start Guide

**IMPORTANT:** Please read the Important Safeguards before using your appliance.

## Thermal safety cutout

Your fan is fitted with an internal thermal safety switch. This will stop the fan from operating if the internal temperature exceeds the normal operating temperature. If this happens refer to the 'Thermal Safety Cutout' on page 9.

## Preparing

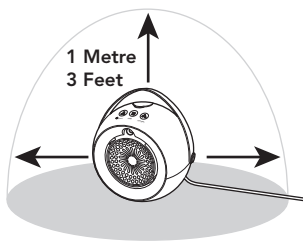

Ensure there is a minimum of 1 metre (3 feet) of clear space all around the fan.

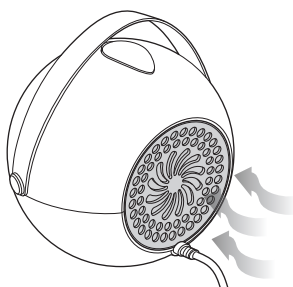

**IMPORTANT:** Ensure that no items can block the air intake on the back of your fan.

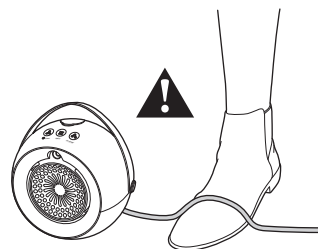

**IMPORTANT:** Ensure that the power cable is not a trip hazard.

## Filling the water tank

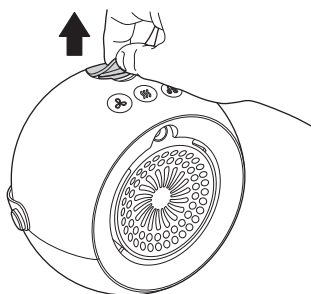

Pull the water tank lid upwards.

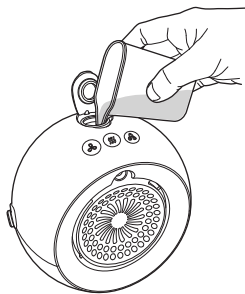

Fill the tank using the water jug provided with demineralize or filtered water.

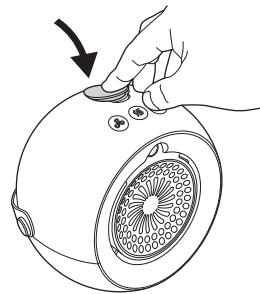

Close the water tank lid and push down to ensure it is fully closed.

## Controls

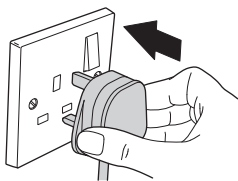

Slot the plug into a mains socket and switch the power on at the socket if required.

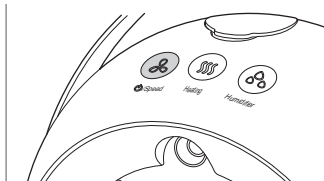

When you plug the fan in you will hear a 'beep' and the **⏻/Speed** icon will flash.



⏻/Speed

Heating

Humidifier

Press the **⏻/Speed** button to turn your fan on.



⏻/Speed

### ⏻/Speed button

**Press and hold for 1.5 seconds:** Unit will beep and turn on to low speed fan, white icon on.

**Press and hold for a further 1.5 seconds:** Unit will beep then a double beep and switch to high speed fan, Blue icon on.

**Press and hold for a further 1.5 seconds:** Unit will beep and turn back to low speed fan, white icon on.

**Press to turn unit off.**



Heating

### Heating button

**IMPORTANT:** The fan must be on to use this function.

**Press once:** Turn heater ON, white icon.

**Press again:** Turn heater OFF, icon not illuminated.



Humidifier

### Humidifier button

**IMPORTANT:** The water tank must be filled to use this function.

**Press once:** Turn humidifier ON, white icon.

**Press again:** Turn humidifier OFF, icon not illuminated.

## Hand warmer

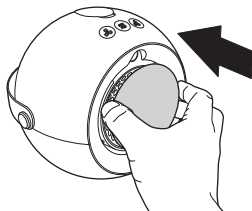

Place the hand warmer on the front of the fan. The hand warmer is held in place with magnets.

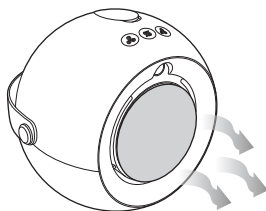

Turn the fan to high speed, and the heater on. Leave the hand warmer attached for a minimum of 10 minutes.

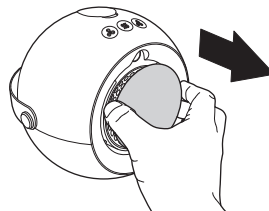

Turn the fan off. **Wait for 2 minutes.** Grip the sides of the hand warmer and pull it off the front of the fan.

# Index

## Topic

---

Important safeguards	05
What water to use?	09
Thermal safety cutout	09
Box contents	10
Parts of your fan	10
Preparing your fan	11
Filling the water tank	12
Using your fan	13
Using the hand warmer	15
Descaling your water tank	16
Storing & cleaning your fan	17
Troubleshooting	18
Specification	18

# Important Safeguards

When using electrical appliances, basic safety precautions should always be followed including the following:

- **Read all instructions before using this product.**
- When using any electrical appliance, basic safety precautions should always be followed including the following:
  - Check that the voltage of the main circuit corresponds with the rating of the appliance before operating.
  - Please ensure that the appliance is used on a stable, level, and heat resistant surface.
  - DO NOT immerse cords, plugs or any part of the appliance in water or any other liquid.
  - DO NOT leave the appliance unattended while it is operating.
  - Close supervision is necessary when any appliance is used by or near children or pets.
- This appliance can be used by children aged from 8 years and above and persons with reduced physical, sensory or mental capabilities or lack of experience and knowledge if they have been given supervision or instruction concerning use of the appliance in a safe way and understand the hazards involved.
- Children shall not play with the appliance.
- Children of less than 3 years should be kept away unless continuously supervised.
- Cleaning and user maintenance shall not be made by children without supervision.
- Children aged from 3

## Important Safeguards (cont...)

years and less than 8 years shall only switch on/off the appliance provided that it has been placed or installed in its intended normal operating position and they have been given supervision or instruction concerning use of the appliance in a safe way and understand the hazards involved. Children aged from 3 years and less than 8 years shall not plug in, regulate and clean the appliance or perform user maintenance.

- Switch off at the wall socket then remove the plug from the socket when not in use or before cleaning.
- If the supply cord is damaged, it must be replaced by the manufacturer, its service agent or similarly

qualified persons in order to avoid a hazard.

- If the supply cord or appliance is damaged, stop using the appliance immediately and seek advice from the manufacturer or its service agent or a similarly qualified person.
- **CAUTION:** In order to avoid a hazard due to inadvertent resetting of the thermal cut-out, this appliance must not be supplied through an external switching device, such as a timer, or connected to a circuit that is regularly switched on and off by the utility.
- **DO NOT** let the cord hang over the edge of a table or counter or let it come into contact with any hot surfaces.
- The use of accessory attachments is not

## Important Safeguards (cont...)

- recommended by the appliance manufacturer, apart from those supplied with this product.
- DO NOT pull the plug out by the cord as this may damage the plug and/or the cable.
  - DO NOT use this product for anything other than its intended use.
  - This appliance is for household use only.
  - DO NOT carry the appliance by the power cord.
  - DO NOT use the appliance outdoors.
  - Use the appliance in a well ventilated area.
  - DO NOT use the appliance near explosive and combustible gas. Avoid long-term direct solar radiation.
  - DO NOT locate the item directly below the socket outlet and outdoor.
  - DO NOT use the same socket with other items.
  - After adding water to the water tank, DO NOT tilt or knock the appliance. If you wish to move the appliance, please push it slowly from the side in order to avoid spilling.
  - DO NOT cover the wind outlet.
  - DO NOT use the appliance near water.
  - Caution: DO NOT operate the appliance with wet hands.
  - CAUTION: Some parts of this product can become very hot and cause burns. Particular attention has to be given where children and vulnerable people are present.
  - In the unlikely event the appliance develops a fault, stop using it immediately and

## Important Safeguards (cont...)

seek advice from the Customer Support Team.

- **WARNING:** In order to avoid overheating, do not cover the heater.
- The heater must not be located immediately below a socket outlet.
- Do not use this heater in the immediate surroundings of a bath, a shower or a swimming pool.
- **WARNING:** This heater is not equipped with a device to control the room temperature. Do not use this heater in small rooms when they are occupied by persons not capable of leaving the room on their own, unless constant supervision is provided.
- Care should be taken when using the appliance due to the emission of hot water vapour. Unplug the

appliance during filling and cleaning.

- If you require any more information or assistance, please contact our Customer Services Team - their opening hours are as follows:

8:00am - 7:30pm  
(Monday - Friday)

8:00am - 1:00pm  
(Saturdays and Sunday)

You can contact them between these hours on:

0344 800 0631 (UK customers)

0412 132 998 (Irish customers)

Alternatively you can send them an email on [CustomerCare@highstreettv.com](mailto:CustomerCare@highstreettv.com)

## What water to use?

- For the best results and to prolong the life of your appliance, we recommend that you use demineralised, distilled or filtered water. This will prevent the build up of limescale inside your fan.
- You can use tap water, but you will have to regularly descale your fan following the instructions given on pages 16.

## Thermal safety switch

Your fan is fitted with an internal thermal safety switch. This will stop the fan from operating if the internal temperature exceeds the normal operating temperature.

### IF YOUR HEATER SHUTS DOWN

- Turn the fan off by removing the plug from the mains socket.
- Leave the fan to cool for approximately 10 minutes or until the fan feels cool.
- Plug the fan back into the mains socket and turn on as usual.

The product and its packaging have been manufactured from valuable materials that can be recycled. Recycling reduces the amount of refuse and helps to preserve the environment.

Dispose of the packaging at a recycling point that sorts materials by type. Make use of the local facilities provided for collecting paper, cardboard and light weight packaging.



Appliances marked with this symbol must not be disposed of along with normal household waste!

You are legally obliged to dispose of old appliances separately from household waste.

Information about collection points where old appliances can be disposed of free of charge is available from your local authorities.

## Box Contents

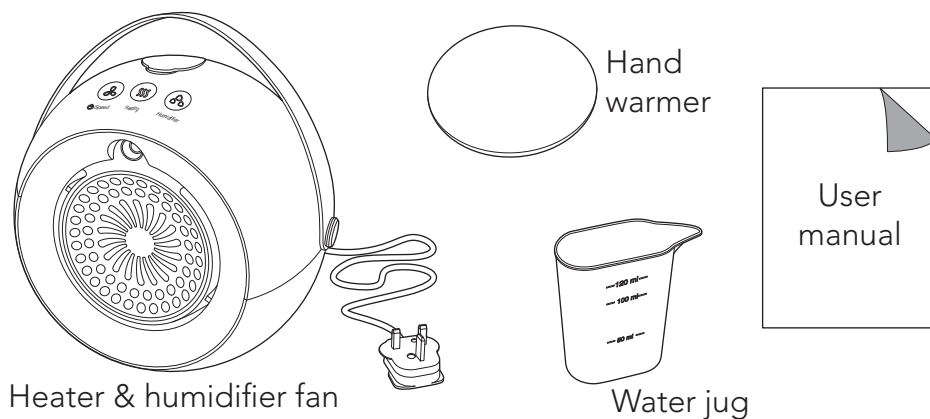

## Parts of Your Fan

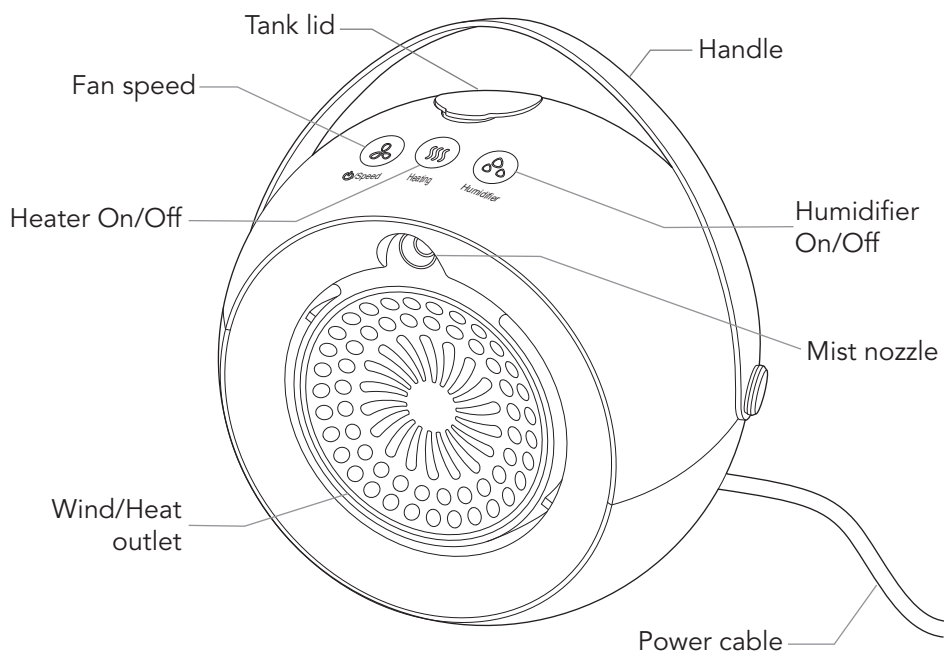

## Preparing Your Fan

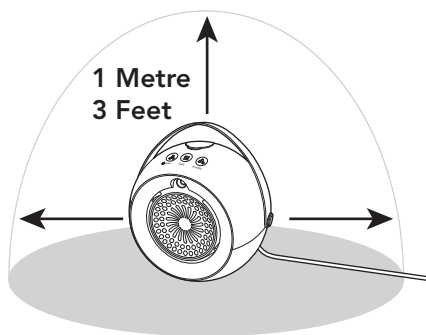

Place your fan in the room you wish to use it in with a minimum of 1 metre (3 feet) of clear space all around it.

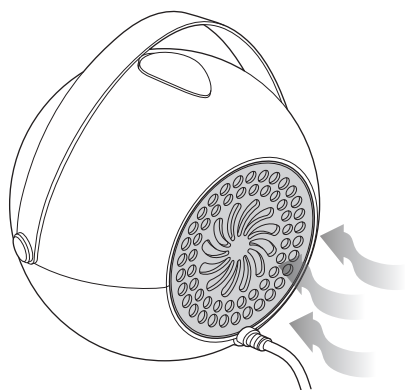

**IMPORTANT:** Ensure that no items can block the air intake on the back of your fan, such as curtains, fabric covers or furniture.

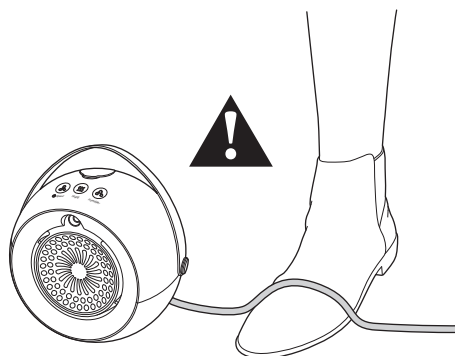

**IMPORTANT:** Ensure that the power cable is positioned so that it does not present a trip hazard on the floor or can be snagged and accidentally pulled off a raised surface.

## Filling The Water Tank

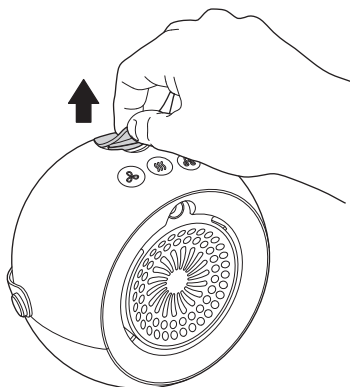

Pull the water tank lid upwards.

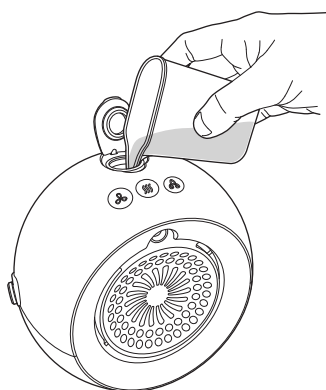

Fill the tank with water using the water jug provided ensuring you use demineralize or filtered water.

**Tank capacity:** 130ml. To prevent over filling and spillage we recommend filling to 120ml using the measuring jug provided.

**IMPORTANT:** Never place scent or other chemicals in the water tank as they could damage the fan.

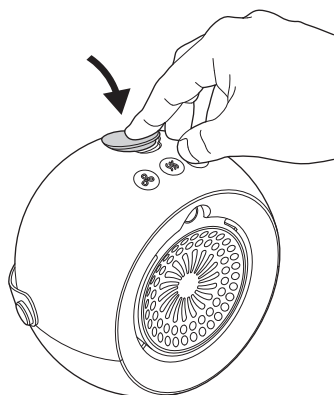

Close the water tank lid and push down to ensure it is fully closed.

# Using Your Fan

**IMPORTANT:** Your fan is fitted with an internal thermal safety switch to prevent your fan from overheating. If this is tripped your fan will shutdown and cannot be used. See page 9 for what to do if this happens to your fan. Your fan also has an automatic shut off function if it is accidentally tipped over. If this happens simply stand it back up correctly and it will reset. Simply start again the required functions.

Please ensure your fan is always placed on a level and stable surface, otherwise it will not switch on.

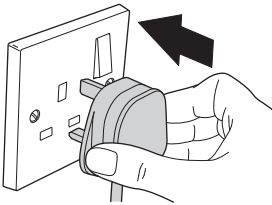

Slot the plug into a mains socket and press the power switch on the socket to the on position if required.

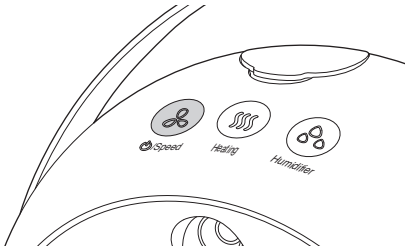

When you plug the fan in you will hear a 'beep' and the **⚡/Speed** icon will flash white.

## Using the fan function

Press the **⚡/Speed** button to:

**Press and hold for 1.5 seconds:** Unit will beep and turn on to low speed fan, white icon on.

**Press and hold for a further 1.5 seconds:** Unit will beep then a double beep and switch to high speed fan, Blue icon on

**Press and hold for a further 1.5 seconds:** Unit will beep and turn back to low speed fan, white icon on.

**Press to turn unit off**

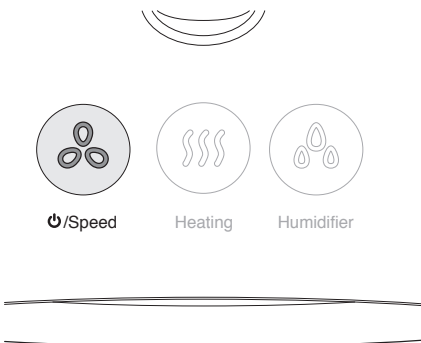

## Using Your Fan (cont...)

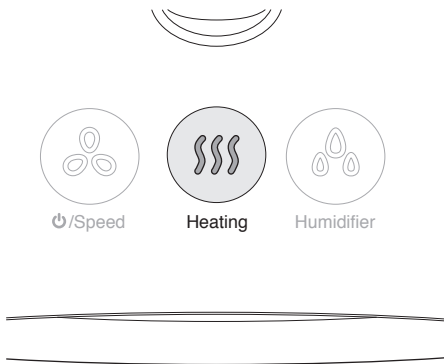

### Using the heating function

Whilst the fan is running at low or high speed, press the **Heating** button to turn the heater on or off.

**ON:** White icon.

**OFF:** Icon not illuminated.

**IMPORTANT:** The fan must be turned on to use this function.

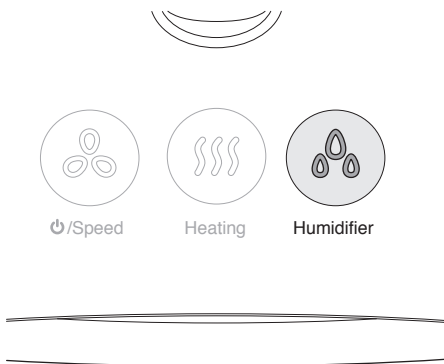

### Using the humidifier function

Ensure the water tank is full before using this feature.

Whilst the fan is running at low or high speed, press the **Humidifier** button to switch the humidifier on or off.

**ON:** White icon.

**OFF:** Icon not illuminated.

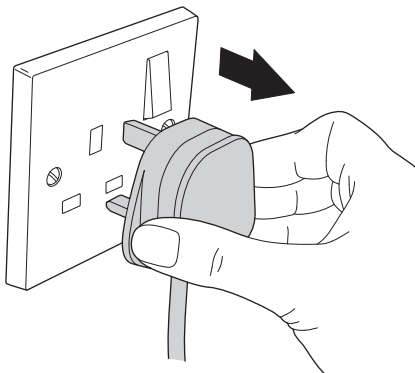

### Turning the fan off

Switch the heater or humidifier off by pressing the required button.

Press the **Speed** button until the icon flashes.

**IMPORTANT:** The fan will continue to run for approximately 10 seconds to cool the unit down.

After the fan has stopped, you can remove the plug from the mains socket to completely turn the fan off.

## Using The Hand Warmer

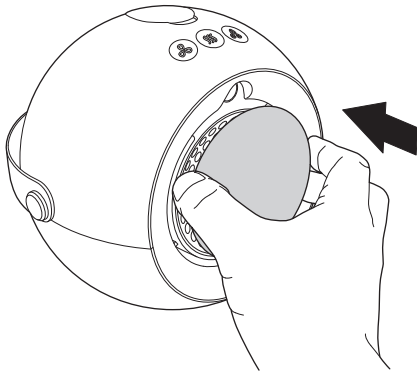

Place the hand warmer on the front of the fan.

The hand warmer is held in place with magnets.

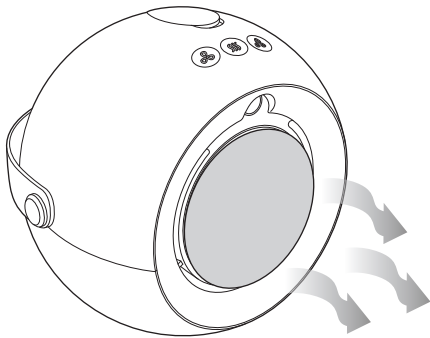

Turn the fan to high speed, then turn the heater function on.

Leave the hand warmer attached to the front of the fan for a minimum of 10 minutes.

**Note:** The longer you leave the hand warmer attached to the front of the fan, the longer it will stay warm.

When the hand warmer is attached to the front of the fan the fan output will be less powerful.

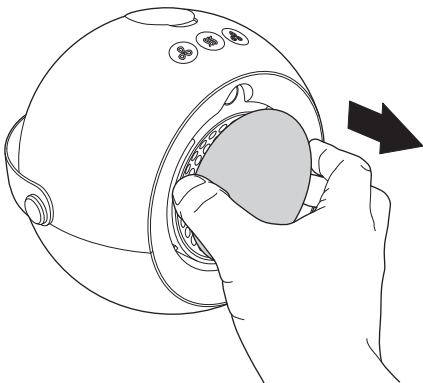

Turn the heater function off then turn the fan off. **Wait for 2 minutes.**

Grip the sides of the hand warmer and pull it off the front of the fan.

Your hand warmer is now ready for use.

**Cleaning the hand warmer:** Wipe clean only with a damp cloth.

# Descaling Your Water Tank

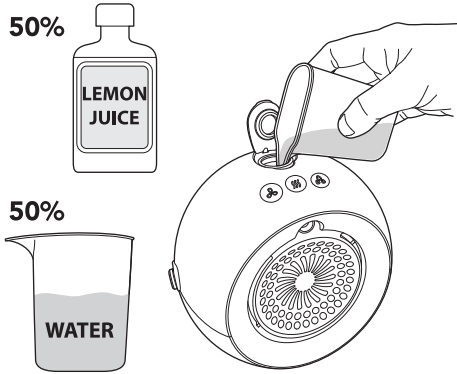

Fill the water tank with 50% lemon juice and 50% water.



⏻/Speed



Heating



Humidifier

Plug your fan in and turn the power on if required.

Press the **Humidifier** button and run until the tank is empty.

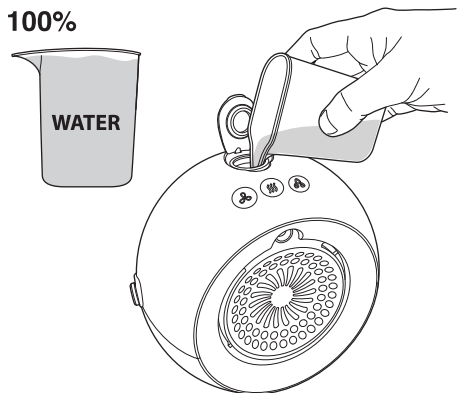

Repeat the process again but only fill the water tank with water and **NO** lemon juice.

# Storing & Cleaning Your Fan

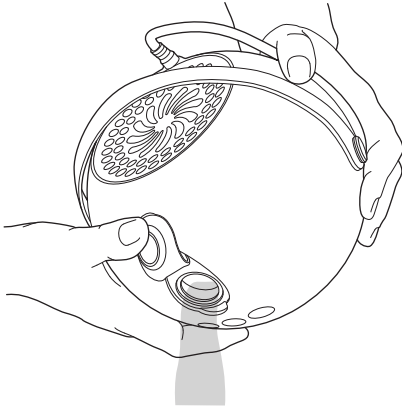

## Emptying the water tank

If you are not going to use the fan for an extended period, empty the water tank.

Open the tank lid and pour any remaining water out.

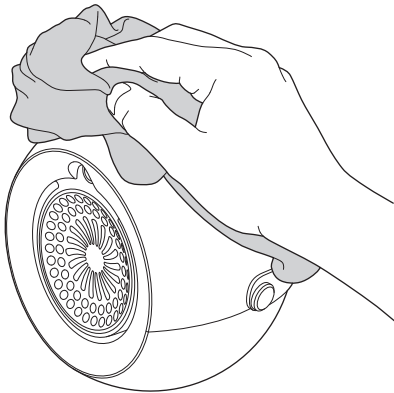

## Cleaning your fan

We recommend that the fan is cleaned at least once a month and always before storing.

Turn the fan off and remove the plug from the mains socket. Allow to cool before cleaning. Wipe the surface of the fan with a dry cloth

# Troubleshooting

## If your fan is not working check the following:

- Be sure to it is plugged in and the power switched on.
- Check for any obstructions. If you find an obstruction, turn the fan off and unplug it. Leave the fan to cool down for at least 10 minutes. Carefully remove the obstruction. Plug the fan back into the power socket and press the **⏻/Speed** button to restart your fan.
- If you are still have the same problem, remove the plug from the mains socket and have the appliance serviced by an authorised service personnel only.

# Specification

Heater On/Off	EP1165
Wattage	400W
Voltage	220 - 240V
Hertz	50 - 60Hz

# Notes

**high**  
street   
**Need help?**  
**We're here**  
**for you**

Visit  
**HighStreetTV.com/Support for:**



FAQ'S



Video Guides



Register your product

Join our community



Distributed by:  
HSTV Corby  
PO Box 7903  
CORBY  
NN17 9HY

Model number: EP1165  
V6-05/20

Please recycle our product and  
packaging where facilities exist.  
Check with your Local Authority  
or retailer for recycling in your  
country.

